

# CEILING - BULWARK - RECESSED



EXTERIOR DOWNLIGHT

SCREW MOUNTING

## STEEL 8R SC - AG

Round lighting fixture with aluminium anti-glare ring and beam angle options for different light distributions. Protection glass is positioned between frame and anti-glare. With STEEL 8 Series elegant design meets high output and optimal efficiency, in a watertight assembly.

**Materials:**

AISI 316L stainless steel body, hard anodised aluminium heat sink and anti-glare and PMMA lens.

**Finishes:**

Frame comes in standard plus custom colours on request.

**Applications:**

Suitable for general and uniform lighting of outdoor areas and side decks, these downlights cover all design needs when combined with smaller products and optimal beam angle selection.



WITH ANTI-GLARE

**DRAWING**

CEILING / BULWARK MOUNT

POSITION THE FIXTURE, THEN USE THE FOUR SCREWS FROM FRONT TO FIX IT AND FINALLY SCREW THE BEZEL.

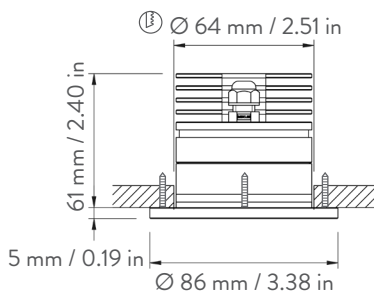
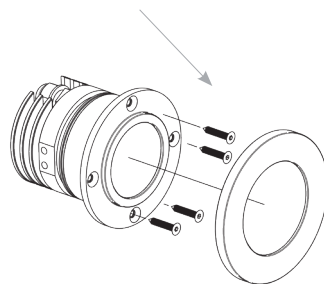
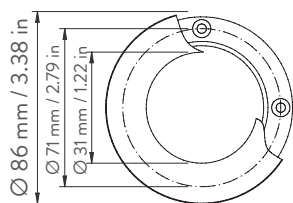

**PHOTOMETRIC DIAGRAMS**

LENS: MEDIUM BEAM: 21°

Cone Diagram		
Lux	h/m	Ø/m
3646	1	0.37
912	2	0.74
405	3	1.11

Lumen: 754  
Watt: 9  
Lm/W: 83  
CCT: 3000K  
CRI: 92 TYP

LENS: WIDE BEAM: 38°

Cone Diagram		
Lux	h/m	Ø/m
1647	1	0.69
412	2	1.38
183	3	2.07

Lumen: 779  
Watt: 9  
Lm/W: 86  
CCT: 3000K  
CRI: 92 TYP

LED TYPE: CREE®

Note : according to the choice of accessories (sanded glass), please consider the implications on the lumen output and the luminous distribution.

**BODY FINISHES W/ ANTI-GLARE**

STAINLESS STEEL



LACQUERED RAL9010 GLOSS



**ACCESSORIES**

SANDED GLASS



ITEMS	LENSES	COLOUR TEMP.	POWER SUPPLY	BODY FINISHES	ACCESSORIES
CODE	MEDIUM WIDE	2700K 3000K 4000K	CLL Vdc 24-32 DRIVER INCLUDED CSL Vf 16.5 If 500 mA DRIVER NOT INCLUDED	POLISHED STAINLESS STEEL LACQUERED RAL9010 GLOSS	SANDED GLASS
20SRSC8	MB - WB	2 - 3 - 4	D - N	SB - LB	SG



Information provided with this document may be subject to change at any time.

RELEASED ON 13.05.2019